

SCHOOL MUSEUM MAP

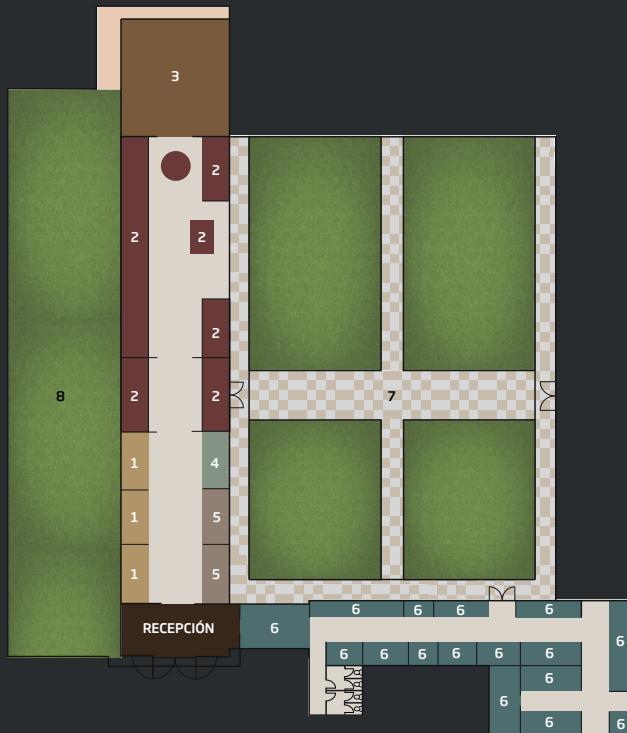

- Reception
- 1. Traditional living
- 2. Agricultural work and trades
- 3. Years of change
- 4. Temporary exposure
- 5. Thematic exhibitions
- 6. Shops
- 7. Garden
- 8. School Garden

OPENING HOURS

- Monday - Friday: 09.00 - 13.30 and 16.00 - 18.00
- Saturday, Sunday and bank holidays: 11.00 - 14.00
- From July 1 to September 15: 09.00 - 13.30

In collaboration with the tourist brand



Ajuntament d'Elx



TOTS A UNA VEU



Partida de Puçol, 8 · 03296 · Elche (Alicante)
 Telf. 965 938 985 - 965 938 986
 comunicacion@museopusol.com
 museopusol@gmail.com

www.museopusol.com



PUSOL MUSEO ESCOLAR

HISTORY



Puçol School Museum is the result of an educational project that since the 1970's has been developed in the unitary school of the small town of Puçol. This activity, linked to the project "The school and its environment" develops the research, recovery and conservation of the traditional culture and heritage of the city of Elche.

In 2009, UNESCO included the educational project in the Register of Good Safeguarding Practices of Intangible Cultural Heritage. Since then, the museum has received the awards of Europa Nostra e Ibermuseos and the medals of cultural merit from the Generalitat Valenciana and the City Council of Elche.



EXHIBITION

Visiting the Puçol School Museum is a journey into the past. The museum recovers and recreates the traditional country house, the typical agricultural work and the urban environment of the city, with the reconstruction of its most popular shops. It's a tour that's completed with a visit to the orchard and garden, which contains the native flowers and crops from Elche's countryside and the Mediterranean area.

The Project has ethnographic and environmental depth of extraordinary value, unique and unparalleled, exceeding 80.000 items, among which are spoken objects and records of the countryside and the city of Elche, and some towns in the surrounding area.

EXPERIENCES



The museum offers group tours where they can discover the life of yesteryear with its jobs, customs and traditions; in addition, schools and foundations can walk through it under the guided knowledge of the students of the Puçol School**.

For a complete experience, the tour is complemented by local craft workshops and traditional games. The goal is to get a hands on closer look to the past ways of life, through the participation and experimentation by both children and adults.



**Groups of at least 10 people. Booking required. Tel: 965 938 985 · 986.*

***Only in the morning and during weekdays, with prior booking.*